

TEESTA- V POWER STATION**INFRA DIVISION****Rev-REQUEST FOR PROPOSAL (RFP)**

Name of work: **Request for technical and commercial proposal for** "Supply, Erection & Fixing of Pre-fabricated (Super-Structure) temporary structure for Kendriya Vidyalaya (single story) at Teesta-V Power Station, Balutar, Singtam, Distt- Gangtok, Sikkim".

Disclaimer

This RFP is neither an agreement and nor an offer by NHPC to the prospective Bidders or any other person. The purpose of this RFP is to provide interested parties with information that may be useful to them in submitting their proposals pursuant to this RFP. This RFP includes statements, which reflect various assumptions and assessments arrived in relation to the Project. This RFP document and any assumptions, assessments and statements made herein do not purport to contain all the information that each Bidder may require. The Bidder shall bear all its costs associated with or relating to the preparation and submission of proposal pursuant to this RFP. Where necessary, NHPC reserves the right to amend or supplement the information, assessment or assumptions contained in this RFP. NHPC also reserves the right to withdraw the RFP or foreclose the procurement case at any stage. The issuance of this RFP does not imply that NHPC is bound to shortlist a Bidder for the Project. NHPC also reserves the right to disqualify any Bidder should it be so necessary at any stage on grounds of National Security.

Requisite details in this regard are attached herewith as under for proposal :

- (i) Detail of Site Location.
- (ii) Scope of work.
- (iii) Drawings- Key Plan & Elevation.
- (iv) Brief of the structure.
- (v) Components of the structure.
- (vi) Technical & Commercial Offer

(i) DETAIL OF SITE LOCATION:

NHPC Ltd (A Govt. of India Navratna Enterprise), Teesta-V PS desires to construct a Prefab structure for Kendriya Vidyalaya at Teetsa-V Power Station, Balutar.

Teesta-V PS (510MW) is located in Gangtok District of Sikkim. The project envisages harnessing of Teesta water, between Dikchu and Sirwani. The site location (proposed prefab KV school) is in Left Bank side, Balutar. Proper approach road is available with adequate of space available for unloading of materials for the structure.

Nearest Railway Station: - Siliguri, approximately 110 Kms from Teesta-V PS, Balutar.

Nearest Airport: - Bagdogra, approximately 110 Kms from Teesta-V PS, Balutar.

Nearest Bus Stop: - Singtam, approximately 06 Kms from Teesta-V PS, Balutar.

(ii) SCOPE OF WORK :

Supply, Erection & Fixing of prefabricated super-structure as per approved drawing upto ceiling height upto 3.50m including all labour and related materials and including super-structure work, internal water supply lines, Internal Electrification works, sewage pit, tile works, door & windows with fittings etc up to commissioning of the structure.

(iii) KEY-PLAN AND ELEVATION :

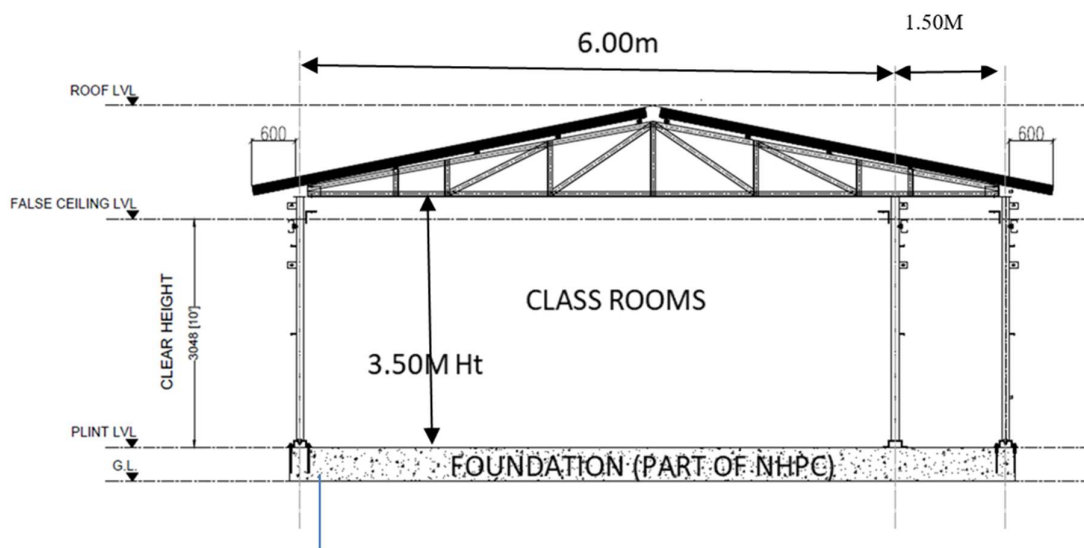

SECTION A-A

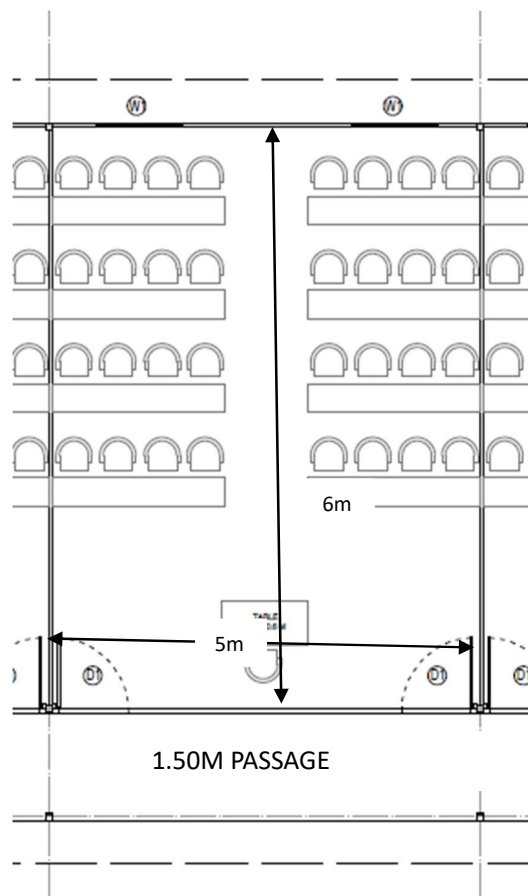

Typical plan of Class-rooms.

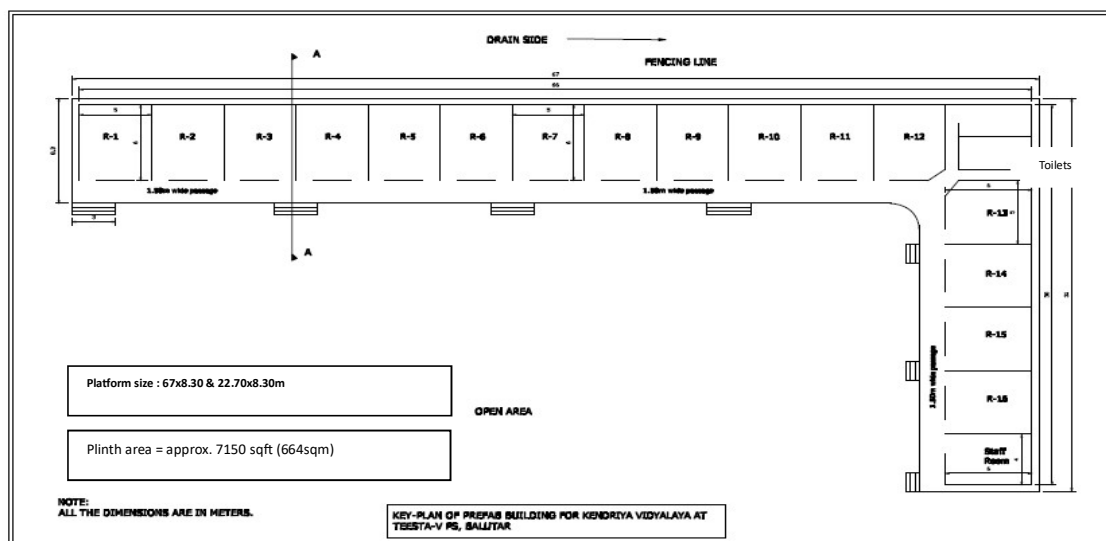

Typical layout plan of pre-fabricated structure

(iv) **BRIEF OF THE STRUCTURE:**

Purpose of building	Class rooms, toilets & staff room required for Class-1 to Class-XII students (approx. 30-40 students in each class)
Plinth Height	50-60cm
Ceiling Height	3.00-3.50m
Class room sizes	Minimum 4x5m
Passage	Min 1.50m
Toilets	Separate Toilets for Boys & Girls
Type of temporary structure required	Temporary Prefabricated shed with proper insulation, internal water supply, sanitary fittings & electrification etc. Adequate Doors, windows, ventilators, passage for school.
Required Plinth area	Apprx 7150 sq.ft

Technical & Commercial Offer for	Rate per sqm/ sqft
Supply, Erection & Fixing of prefabricated super-structure as per approved drawing.	_____ including GST, Carriage, others if any.

(v) TECHNICAL SPECIFICATION OF THE COMPONENTS OF THE PRE-FAB STRUCTURE.

1. Structural Steel:

Structure shall be fabricated of square/ tubular pipes section for columns, purlins and trusses, cold form folded sections for purlins and runners. The steel structure shall be designed as per IS- 800:2007 and as per wind load conditions applicable for the area mentioned in IS 875:1987. All steel member surfaces will be prepared through wire brush with one coat primer and two coat enamels paint.

2. Wall & Partition:

The wall panels shall be made up of 50mm thick composite Solid wall panels/ PUF sandwich wall panels. Proper insulation shall be provided with proper joint bonding filled with silicon or similar products or branded cemented putty to leakage free.

3. Roofing system:

Minimum thickness of 0.50mm profile sheet or PUF Roofing Sandwich panels with proper arrangement for storm water through PVC rain water pipe.

4. Doors:

Providing and fixing 30-35mm thick water proof flush door with M.S Angle, Chalkath with proper fittings or PUF Insulated door and it shall be provided with complete accessories.

5. Windows & Ventilators:

Providing and fixing Pure Polyester Powder coated extruded Aluminum Sliding window and aluminum grill at suitable locations and in sizes as mentioned in drawings with 4mm thick glass. SS wire mesh will be provided with all necessary fittings.

6. Internal Plumbing and sanitary:

All Internal Plumbing line to all fittings and Fixtures shall be within the walls with Chlorinated Polyvinyl Chloride (CPVC) pipes. WC/ Commode with all proper fittings, wash basis, complete tap fittings with UPVC pipes, proper drainage by PVC pipes upto outside manhole as mentioned in the drawings.

7. Painting:

Asian, Berger or equivalent quality weather shield paint for walls. Synthetic enamel paint in M.S structure after applying prime coat.

8. Internal Electrical:

Electrical fixtures like LED tube light, bulk head light, ceiling fans, exhaust fans, modular switch, and socket of 6 Amp, 16 Amp, 25 Amp with GI box and modular plates as per approved drawing and BOQ of make.

NOTE:

- *Levelling of ground, civil Work like foundation, plinth, flooring work etc shall not be in this scope of work.*
- *External Electrical & Plumbing work shall be NHPC's scope.*
- *Furniture is not in the scope of work.*
- *Kindly mention any modifications of the above if requires any.*